

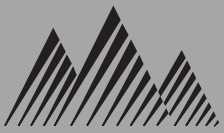

Alpine
Reg No. 95/02606/07



GERMAN KITCHENS

2nd CAESARSTONE
KITCHEN DESIGN COMPETITION – 2011

Featuring: CaesarStone 'NOUGAT'
Designer: Katja Johnson-Wright
Company: Alpine German Kitchens Pty (Ltd)





Katja Johnson-Wright
Designer @ Alpine German Kitchens (Pty) Ltd
katja@agk.co.za
082 924 0146

Lize Collins
CaesarStone Consultant
lize@interslab.co.za
083 230 5967

Cape Town, February 28, 2011

2ND CAESAR STONE KITCHEN DESIGN COMPETITION – ARABELLA COUNTRY ESTATE

Situated on the prestigious Arabella Country Estate, at the foot of the majestic Kogelberg Mountains adjacent to the Bot River Lagoon, this sleek, contemporary Rational kitchen perfectly reflects the textures, lifestyle and natural beauty of the estate.

The beautiful colours and textures used throughout the unique design of this home enhance the experience of complete comfort and warmth.

The CaesarStone material was a natural choice for the environmentally conscious family who likes to entertain in their spacious holiday home. The naturally hygienic qualities of the product and the low maintenance and high durability of the CaesarStone material was as important to the clients as the aesthetic aspect.

This complex kitchen features a successful combination of four vastly different Rational door style ranges called tio, Cambia, Plano and Neos. The majority of the kitchen cabinetry was supplied in Rational's Arctic White high-gloss lacquer which forms a neutral base to the Graphite high-gloss lacquer accents. All the Siemens appliances are built-in or fully integrated in order not to distract from the beautiful surroundings. A solid American Walnut bar entices you to have a cappuccino and some nougat. 'Nougat' 6600 is the name of the 20 mm thick shaded white CaesarStone material the client chose. The classic grain of the stone offers a lovely contrast, reflecting the surrounding stones of the mountains – and, in addition, is echoed in the chosen door front combinations.

The client brief proved to be an exciting challenge:

- Comfortable informal island seating for at least twelve people
- 4 x different work surface zones for food and drinks preparation as well as decorative display
- Coffee station
- Breakfast and wine bar
- Display area incorporating floating shelves, TV entertainment, bridging the kitchen and dining room space
- Importance of maximizing both natural and artificial lights. During the day, generous day-light streams through the picture window and sliding glass doors inviting everyone to have a picnic outside on the rolling lawn or play a round of golf. LED glass shelves, plinth lights and other accent lighting in addition to the recess ceiling lights create a beautiful and dramatic transformation at night.
- Choice of sophisticated and delicate high-gloss, glass, solid wood and CaesarStone finishes which are also durable and easy to clean
- Appliance brief:
 - 1 x 900 mm wide gas hob
 - 1 x 900 mm wide under-counter oven
 - 1 x 600 mm wide eye-level oven
 - 1 x built-in microwave
 - 1 x built-in warmer drawer
 - 1 x fully integrated fridge
 - 1 x fully integrated dishwasher
 - 1 x free-standing fridge/freezer/ice maker,
 - 1 x free-standing washing machine
 - 1 x free-standing tumble dryer
 - 1 x under-slung prep. bowl sink, 1 x under-slung double bowl sink, 1 x deep utility sink
- Organized and space efficient storage incorporating a luxury grocery cabinet, utility cabinet, broom storage, various wooden cutlery & utensil inserts, 3 x pivoting corner carousels, internal drawers and pull-outs, 2 x recycle waste bin storage units, etc.).

Interesting details include the choice of the finger grip profile between the fronts which, in combination with the worktop, maximizes the appeal of the worktop texture and glossy yet earthy door fronts. The centre island is the hub of the kitchen; it's where all of the chosen materials and colours meet – just as the island fulfills its function of bringing people together in the warm social space of the kitchen. This kitchen is a perfect example of the right balance of form and function – it installs a homely confidence within a high-tech environment and perfectly harmonizes with its natural surroundings.

Herewith please find enclosed the proposed floor plan, elevation drawings indicating the respective finishes, 3D colour graphics together with the two photographs for your perusal.

FLOOR PLAN

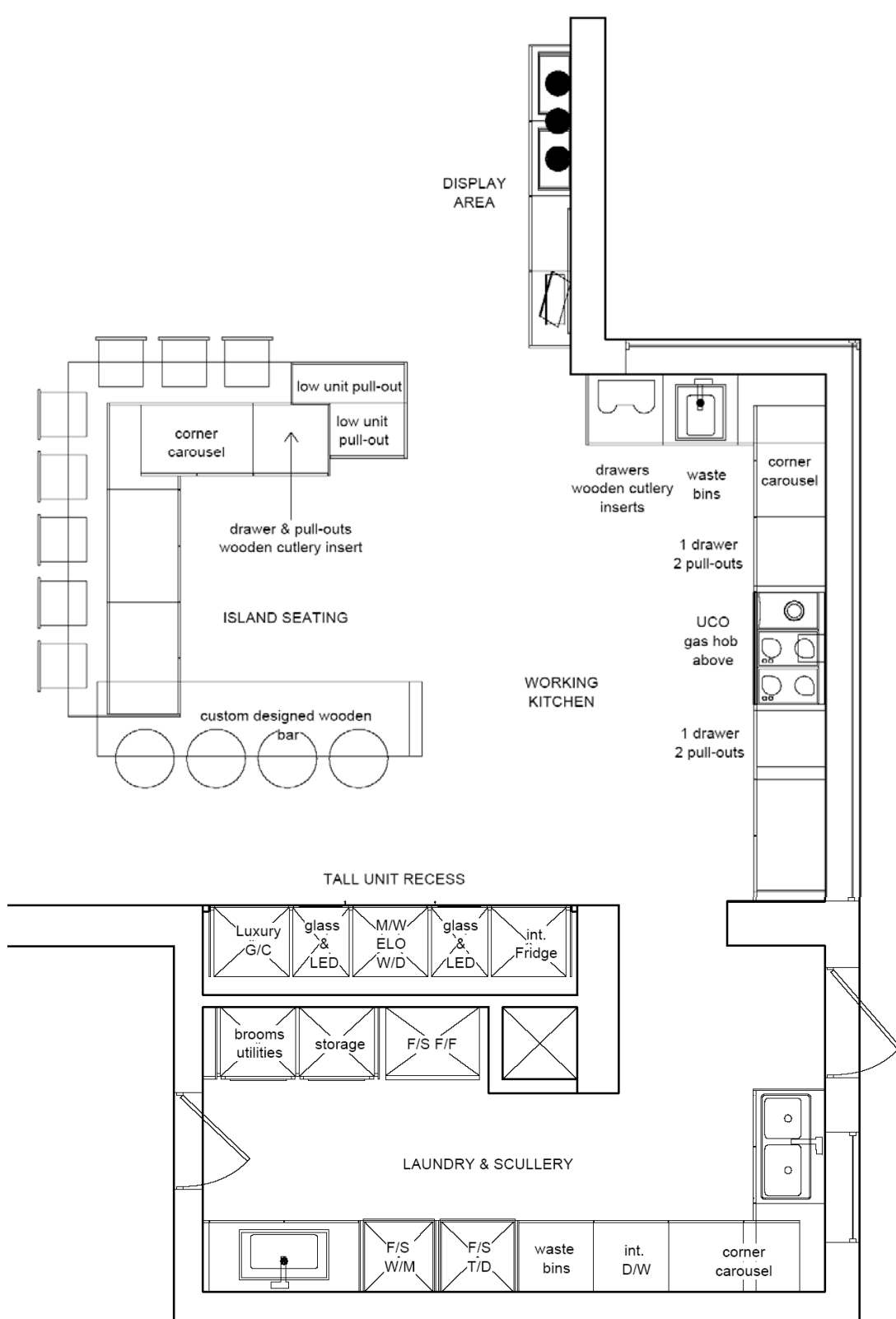

ELEVATION DRAWINGS

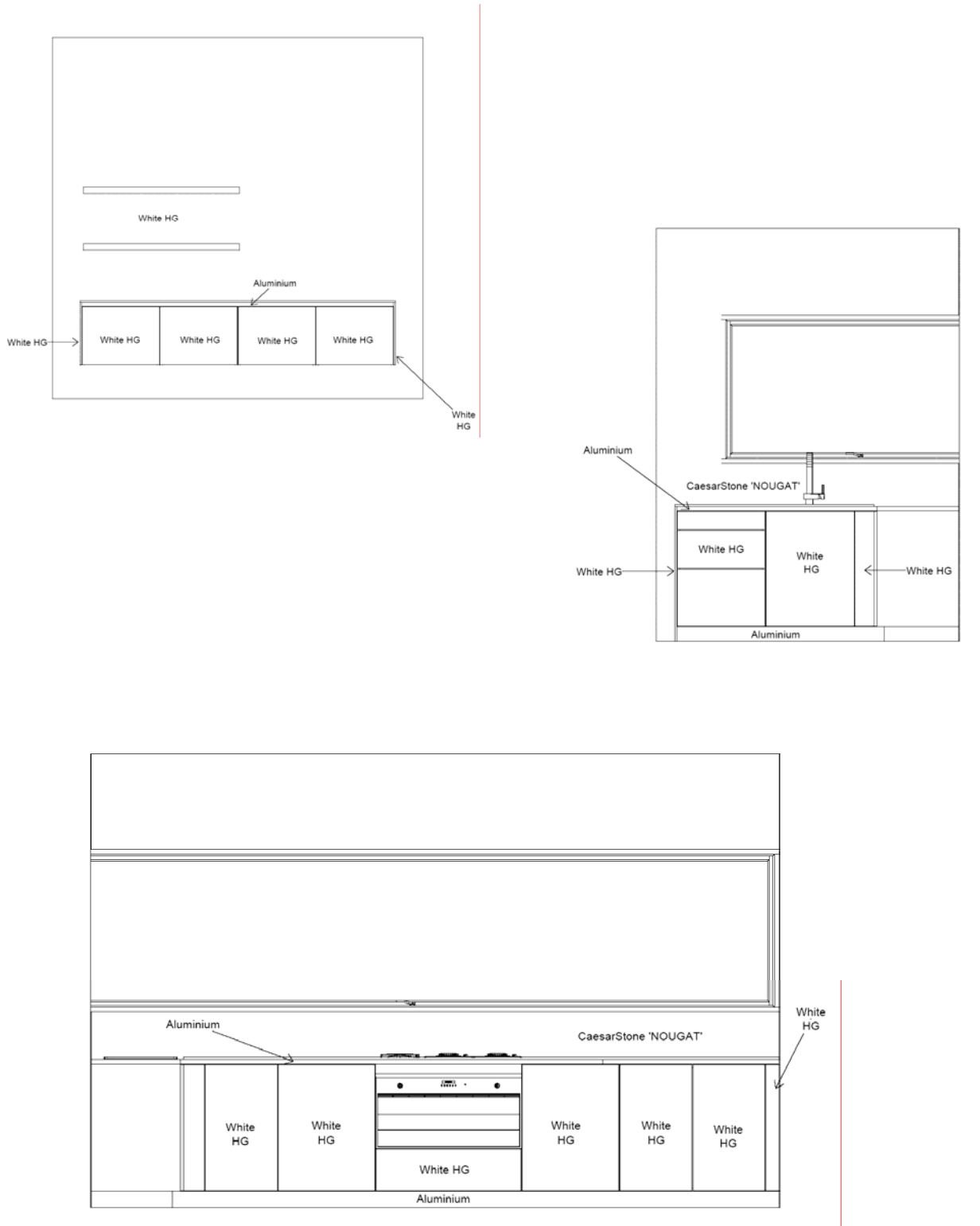

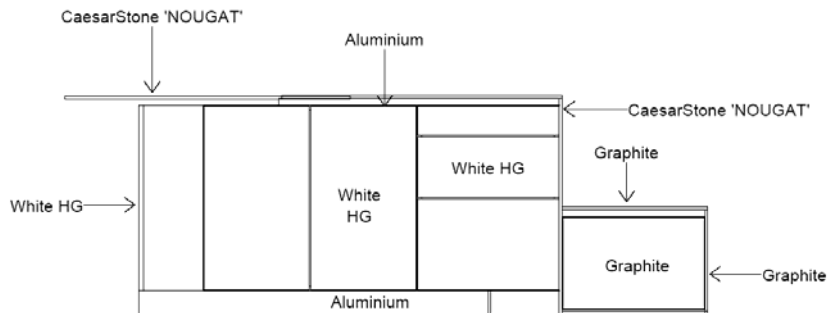
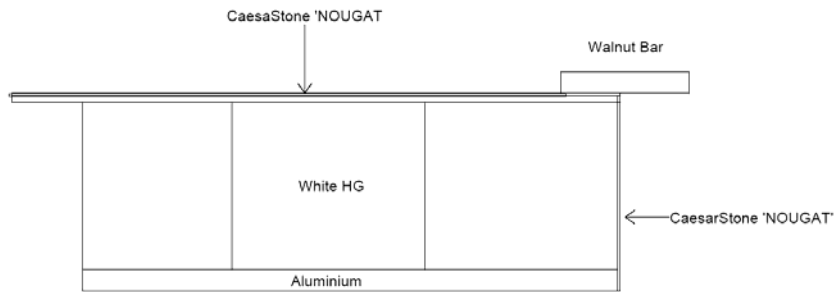
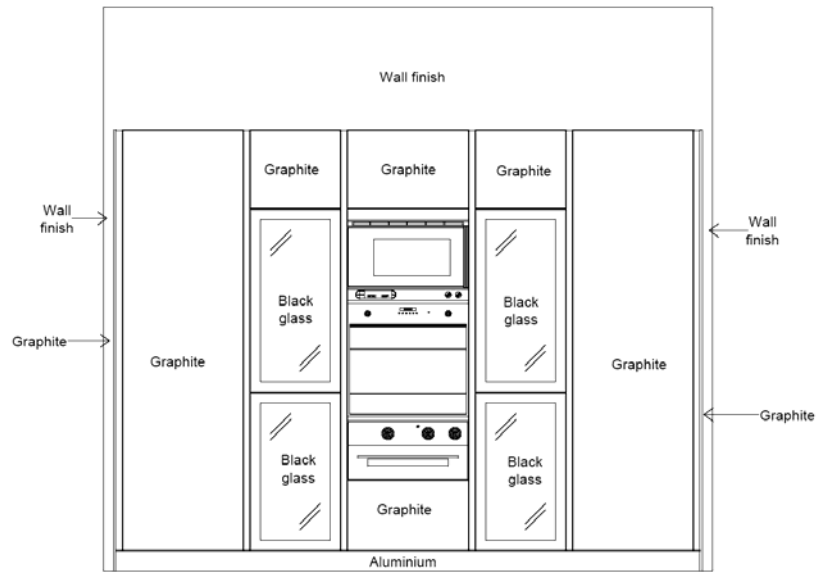

3-D COLOUR IMAGES





COLOUR PHOTOS



